

Product Parts

- 1 - Corners (x4)
- 2 - Center Shock Cord Pole (x1)
- 3 - Vertical Shock Cord Pole (x2)
- 4 - Horizontal Curved Shock Cord Pole (x2)
- 5 - Fabric Graphic (x1)
- 6 - Soft Case (x1) (not shown)

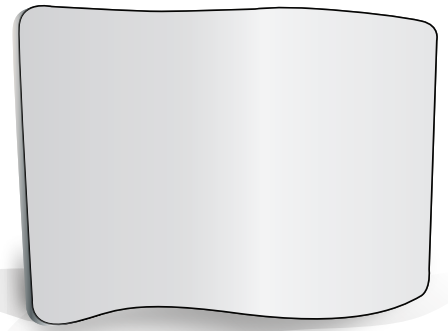
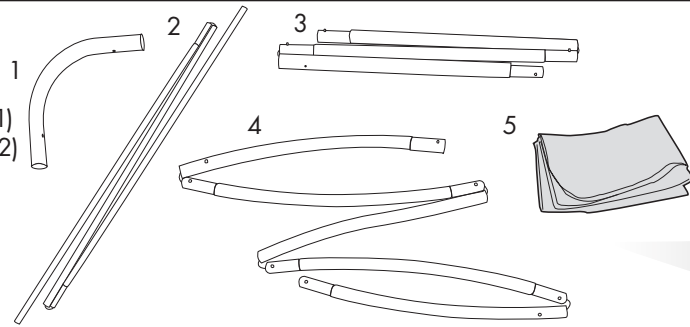

Display Set-Up

Step 1

Begin by removing all parts from the soft carry case and place on a clean, flat surface.

Step 3

Connect the frame pieces together following the # patterns supplied on the pole pieces. Note that the Center Shock Cord Pole (2) will be inserted last.

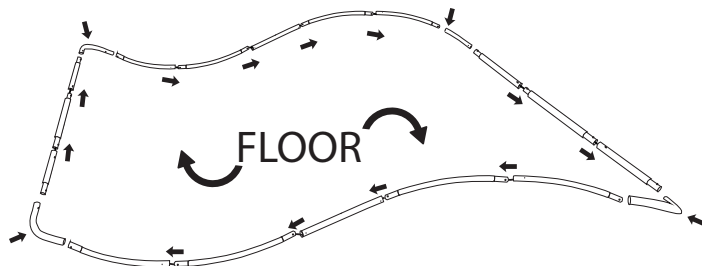

End Result:

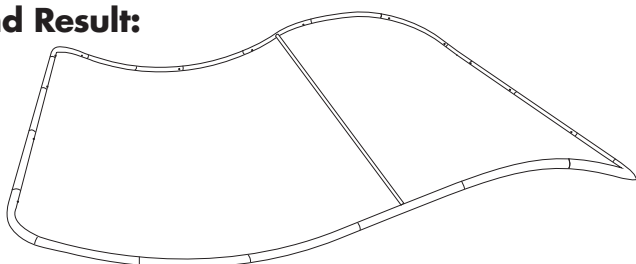

Step 2

Assemble all poles by placing the tapered end of one pole into the large end of the next while pressing the button snap. Overall frame connection view is shown in Step 3. However, it is best to start assembly by connecting all the poles and then attach the Corner (1).

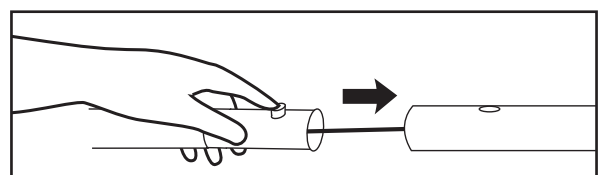
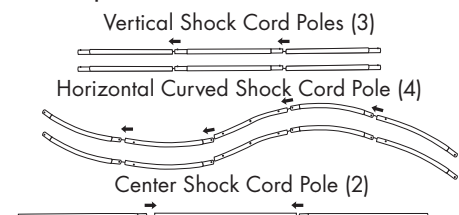

Step 4

Verify the zipper at the bottom of the Fabric Graphic (5) is open and slide the Fabric Graphic over the frame.

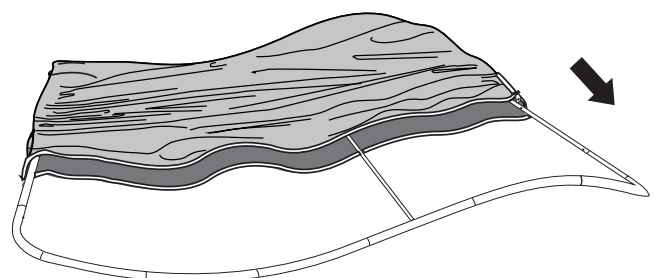

Display Set-Up Continued...

Step 5

Zipper the Fabric Graphic (5) shut at bottom.

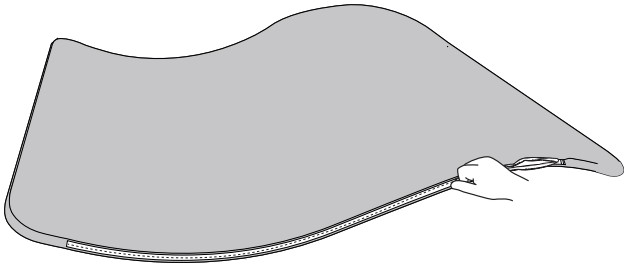

Step 6

Easily lift the display to a Vertical position.

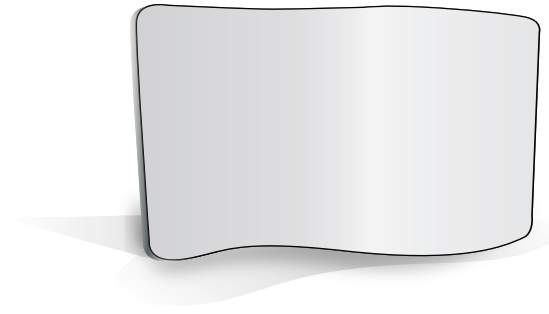

Display Tear Down

Step 1

Verify that the floor surface in front of the Display is clean then lay the Display on the floor. Unzip the bottom of the Fabric Graphic (5)

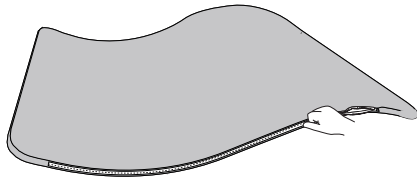

Step 2

Slide the Fabric Graphic off the Frame, fold and put in soft case.

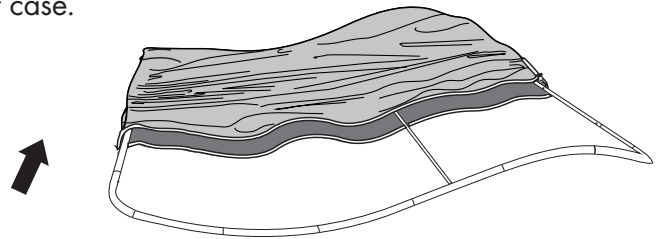

Step 3

Take apart the frame pieces by pressing the button snap and pull the pieces apart. If the button sticks please push the tube forward while twisting and then pull.

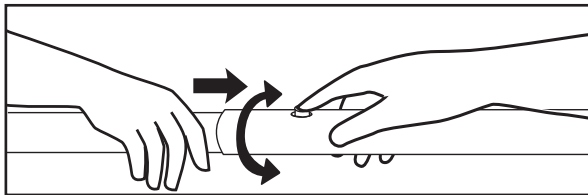

Step 4

Put all frame pieces into soft case.

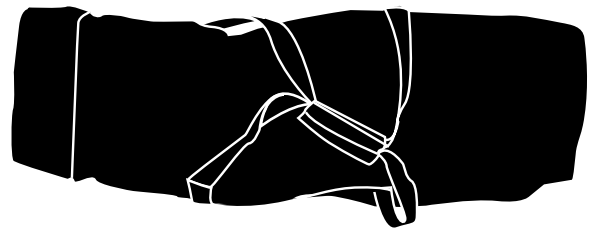

Storage

Place all product parts into Soft Carry Case and store in a cool dry location.

Care

Recommended for indoor use only.

Machine wash on gentle cycle using mild detergent. Line Dry. Do NOT dry clean, Do NOT Iron.

Warranty Information: All products are designed to provide the user with a cost-effective and durable product. Standard warranty is a 'one year parts and labor' warranty which warrants product against defects in material and workmanship. It does not cover damage due to accidents, abuse, or normal wear and tear. Products found to be defective will be replaced or repaired at factory's discretion.